

FILE No.: 232-102-1
 Date Plotted: 12/20/2009, 1:41 PM
 Layout Name: DATA(1)
 File Name: P:\Projects\0594225\UGASHIK\ALP\UGASHIK-DATA.dwg
 Designed By: nilewallyn
 Drawn By: boquinn
 Checked By: bhanson

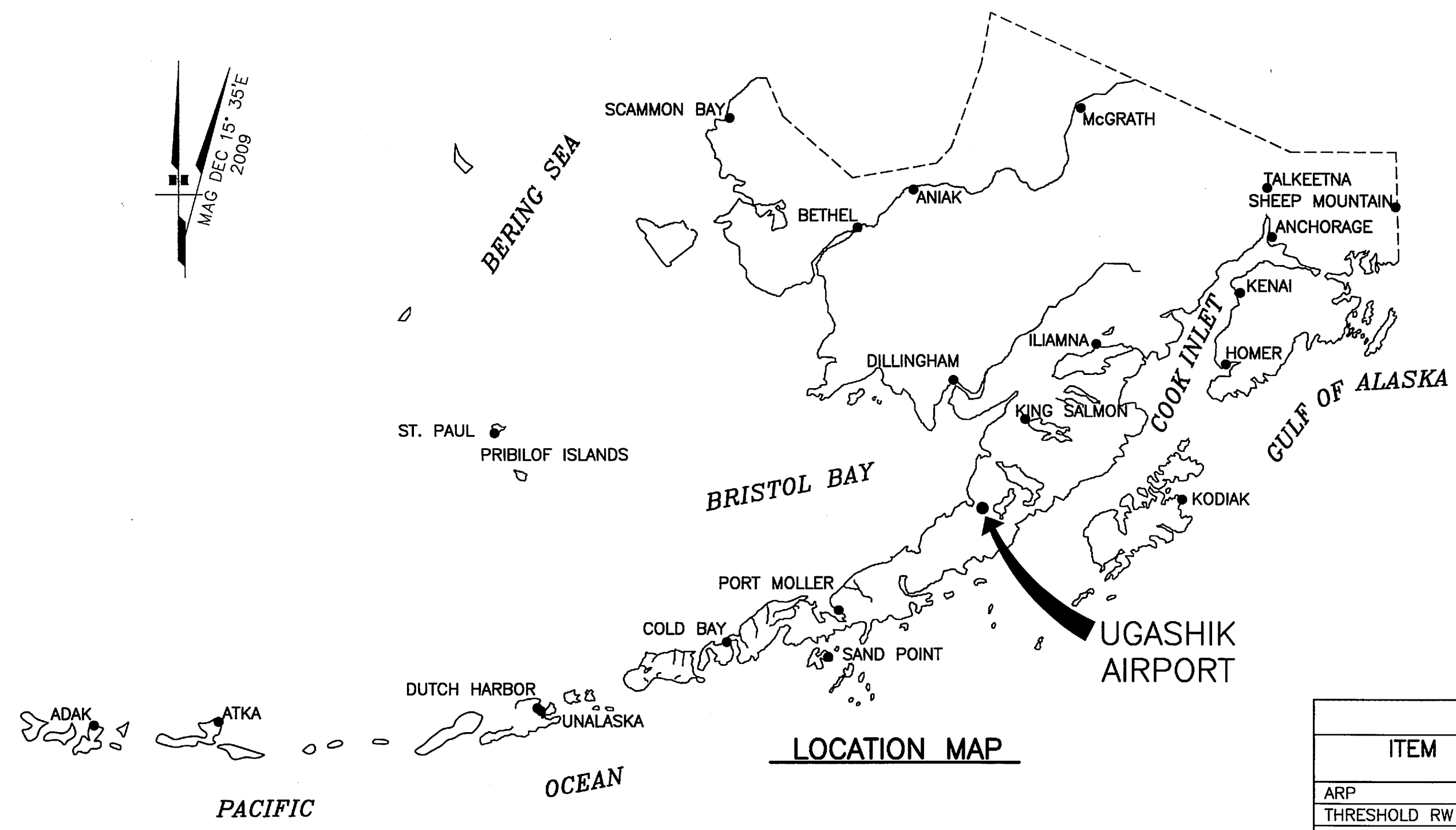

LEGEND		
ITEM	EXISTING	ULTIMATE
AIRPORT REFERENCE POINT (A.R.P.)		
ANTENNA		
BLUFF		
BUILDINGS		
BUILDING RESTRICTION LINE		
FENCE		
PAPI		
PROPERTY LINE		
REIL		
ROADWAYS		
ROTATING BEACON		
SHORELINE		
SURVEY MONUMENT		
THRESHOLD MARKERS/LIGHTS		
TOPOGRAPHIC CONTOURS		
TREE (LARGE SINGLE)		
TREELINE		
VASI		
WIND CONE		
WIND CONE AND SEGMENTED CIRCLE		

AIRPORT DATA TABLE		
ITEM	EXISTING	ULTIMATE
ICAO IDENTIFIER	NONE	
NATIONAL AIRPORT IDENTIFIER	9A8	
FAA SITE NUMBER	50790.1*A	
AIRPORT ELEVATION NAVD88	43.8'	
AIRPORT REFERENCE CODE	A-1	
MEAN MAX. TEMPERATURE, HOTTEST MONTH	58°F, AUGUST	
AIRPORT AND TERMINAL NAVIGATION AIDS	NONE	
TAXIWAY LIGHTING/MARKING	NONE	
OBSTRUCTION SURVEY SOURCE & TYPE	NONE	
MAGNETIC DECLINATION, YEAR, RATE OF CHANGE	15°35'E, 2009, -0°12'(W) / YEAR	

GEOGRAPHIC COORDINATES TABLE				
ITEM	EXISTING LATITUDE	EXISTING LONGITUDE	ULTIMATE LATITUDE	ULTIMATE LONGITUDE
ARP	57°31'24.33"N	157°23'45.58"W		
THRESHOLD RW 6	57°31'21.03"N	157°24'13.30"W		
THRESHOLD RW 24	57°31'27.63"N	157°23'17.86"W		

RUNWAY 6/24 DATA TABLE			
ITEM	EXISTING	NEAR TERM	ULTIMATE
RUNWAY TYPE UTILITY OR OTHER THAN UTILITY	UTILITY		
FAR PART 77 APPROACH CATEGORY (V, NPI, P)	V		
APPROACH SURFACES	20:1		
VISIBILITY MINIMUM	≥1 SM		
RUNWAY SURFACE	GRAVEL		
PAVEMENT STRENGTH SW,DW,DTW,DDTW x1000lbs	N/A		
AIRCRAFT APPROACH CATEGORY	A		
AIRPLANE DESIGN GROUP	I		
TRUE BEARING	N77°31'30"E		
EFFECTIVE GRADE	0.59%		
TOUCHDOWN ELEVATION NAVD88 (ESTIMATED)	43.7' / 43.8'		
RUNWAY DIMENSIONS	60' x 3100'		
RUNWAY SAFETY AREA (RSA) DIMENSIONS	100' x 3500'		
LENGTH BEYOND R/W END	200' / 200'		
RUNWAY PROTECTION ZONE (RPZ) DIMENSIONS	250' x 450' x 1000'		
RUNWAY OBJECT FREE AREA (ROFA) DIMENSIONS	250' x 3580'		
LENGTH BEYOND R/W END OR STOPWAY	240' / 240'		
RUNWAY OBSTACLE FREE ZONE (ROFZ) DIMENSIONS	250' x 3500'		
RUNWAY LIGHTING	NONE		
RUNWAY MARKING TYPE	NONE		
RUNWAY VISUAL APPROACH AIDS	NONE		

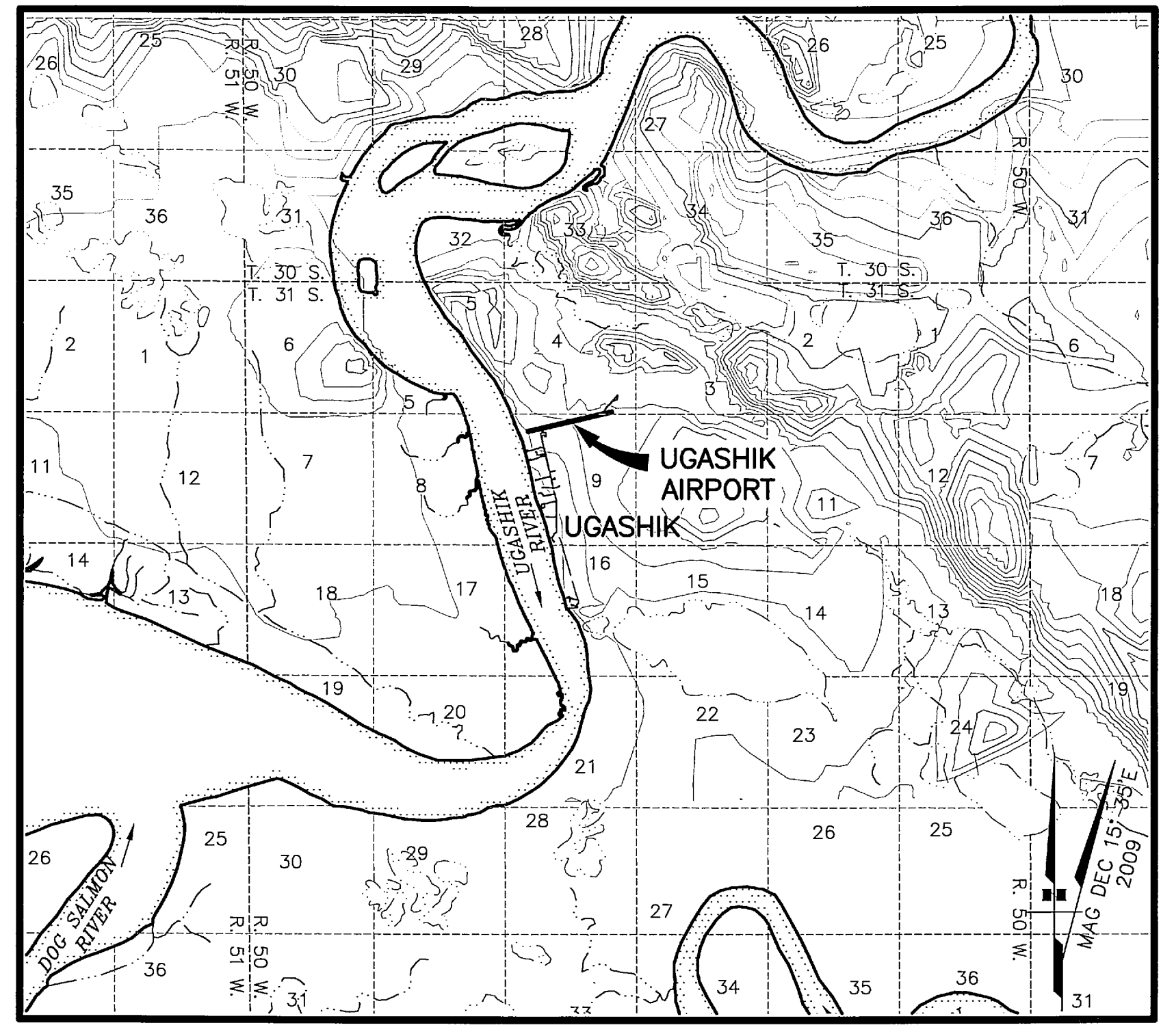
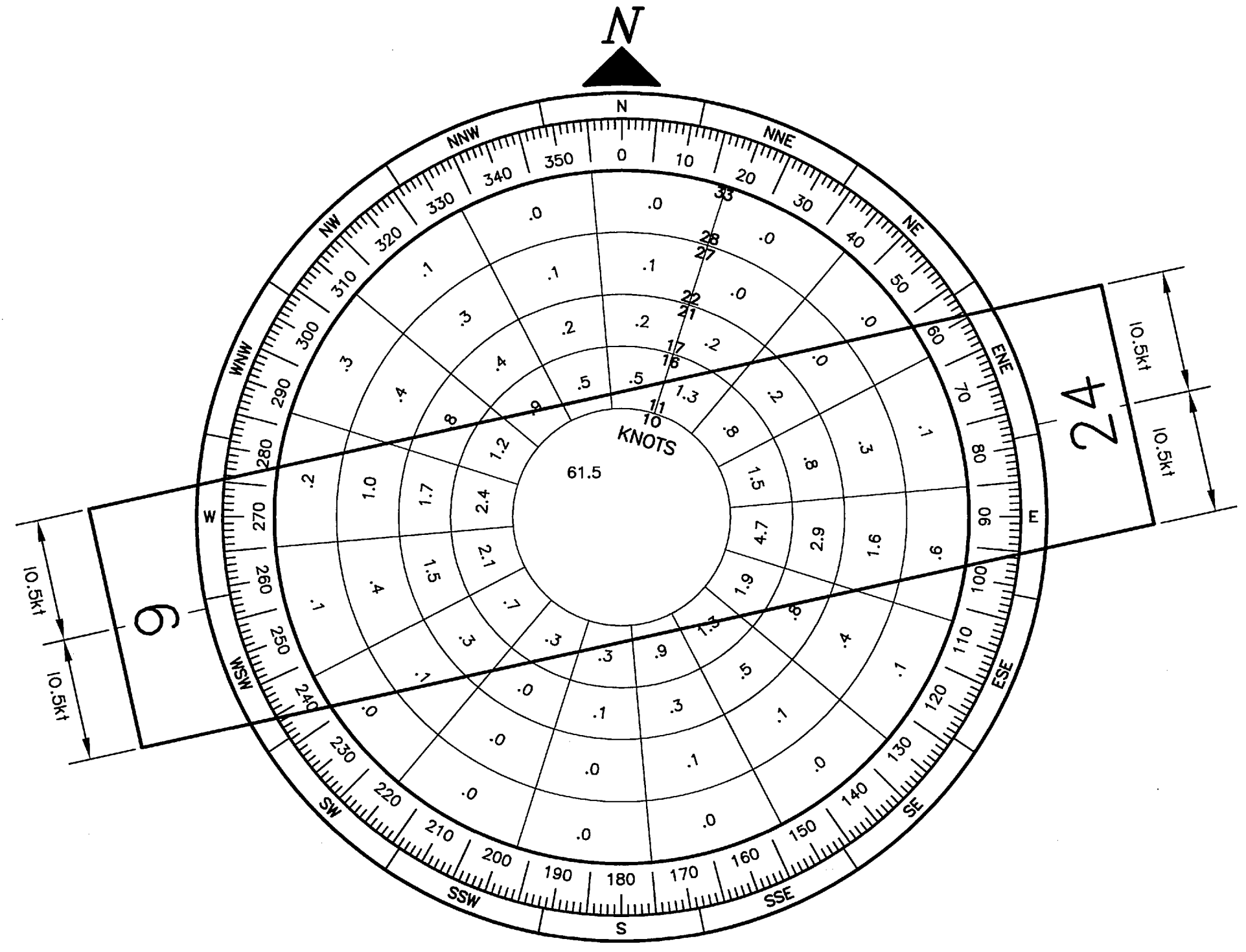

VICINITY MAP
 SEC. 9, T 31 S, R 50 W,
 SEWARD MERIDIAN
 U.S.G.S. UGASHIK (C-5), ALASKA

MODIFICATION TO STANDARDS/ NON STANDARD CONDITIONS			
DESCRIPTION	STANDARD	EXISTING	ULTIMATE
RSA WIDTH	120'	100'	120'
RSA LENGTH BEYOND RUNWAY ENDS	240'	200'	240'

NOTES

1. THE INFORMATION SHOWN HEREON IS BASED ON A FIELD SURVEY PERFORMED BY DOWL ENGINEERS ON JANUARY 23, 2008.
2. THE HORIZONTAL DATUM IS NAD83(CORS96) (EPOCH:2003.0000) AS DETERMINED BY STATIC GPS OBSERVATIONS USING LEICA DUAL FREQUENCY GPS RECEIVERS AND PROCESSED USING THE NGS OPUS UTILITY. CONTROL CORS STATIONS USED FOR THE POSITION SOLUTION WERE TSEA, POTS AND CHIS.
3. THRESHOLD COORDINATES WERE DETERMINED USING A STATIC GPS NETWORK. THE TOPOGRAPHIC MAPPING IN THE AIRPORT VICINITY WAS DIGITIZED FROM USGS QUAD UGASHIK (C-5).

DRAWING INDEX	
SHT #	TITLE
1	AIRPORT DATA SHEET
2	AIRPORT LAYOUT PLAN
3	AIRPORT AIRSPACE

BY: DATE:	REVISION:
APPROVED: <i>K. Kim Rice</i> K. KIM RICE, P.E. PRECONSTRUCTION ENGINEER DATE: 3/13/2009	RECOMMENDED: <i>H. M. Douthitt</i> HARVEY M. DOUTHITT, P.E. DESIGN SECTION CHIEF DATE: 4/29/09

AIRPORT LAYOUT PLAN CONDITIONAL APPROVAL SUBJECT TO ALP APPROVAL LETTER DATED 4/29/2009
 FAA AIRSPACE REVIEW NUMBER: 2008-AAL-181-URA

STATE OF ALASKA
 DEPARTMENT OF TRANSPORTATION
 AND PUBLIC FACILITIES
 CENTRAL REGION

UGASHIK AIRPORT
 UGASHIK, ALASKA
 AIRPORT LAYOUT PLAN
 AIRPORT DATA SHEET

DATE: 02/06/2009
 SHEET: 1 OF 3

NOTES:
 1. THERE IS NO WIND DATA AVAILABLE FOR THE UGASHIK AIRPORT. WIND DATA FROM NEARBY PILOT POINT AIRPORT WAS USED TO CREATE THIS WIND ROSE.
 2. WIND DATA WAS COLLECTED BY THE CITY OF PILOT POINT AWOS FROM 12/11/1992 THROUGH 09/06/1995.

FILE No.: 232-102-2
 Date Plotted: 2/20/2009, 1:40 PM
 Layout Name: LAYOUT(2)
 File Name: P:\Projects\090422\UGASHIK\ALP\ALP-UGASHIK.dwg
 Designed By: nilevellyn
 Drawn By: boquinn
 Checked By: bhanson

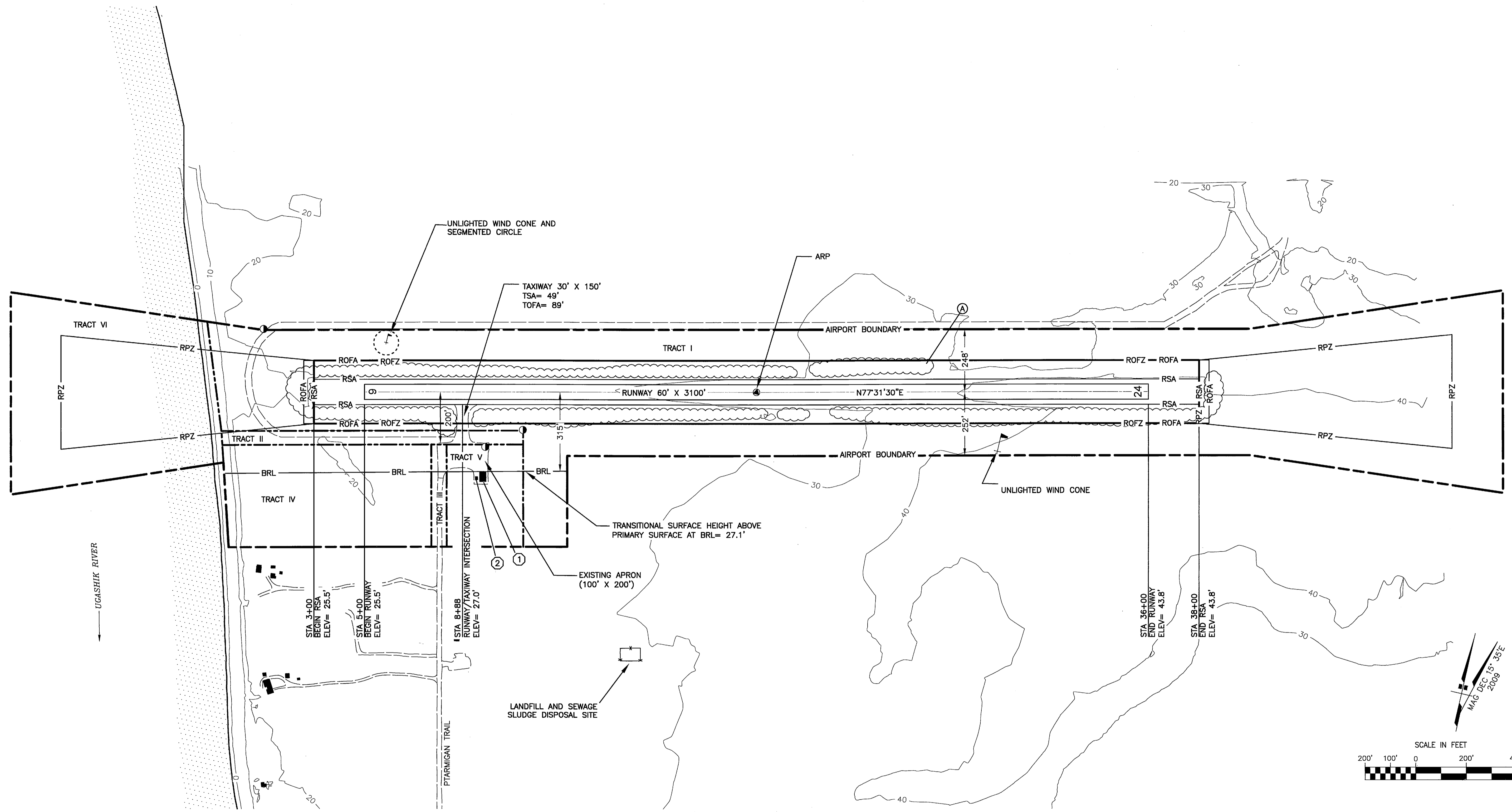

PROPERTY STATUS							
ID #	INTEREST	GRANTOR	GRANTEE	PARCEL SIZE	DATE ACQUIRED	RECORDED DOC NO.	ACQUIRED AIP NO.
TRACT I	30 YEAR LEASE-SURFACE ESTATE			60.64± ac	12-6-82	ADA 11425	
TRACT II	TO BE ACQUIRED			1.64± ac		ADA 11426	
TRACT III	TO BE ACQUIRED			0.55 ac		ADA 11427	
TRACT IV	TOWNSITE TRUSTEE DEED			7.48± ac	6-19-85	ADA 11428	
TRACT V	TOWNSITE TRUSTEE DEED			2.75 ac	6-19-85	ADA 11429	
TRACT VI	AVIGATION & HAZARD EASEMENT			12.72± ac	11-20-81	ADA 11430	

PROPERTY AND TRACT LINES ARE UNSURVEYED AND BASED ON 2002 DCED DATA AND 1986 PROPERTY PLAN.

BUILDING DATA TABLE				
ID #	DESCRIPTION	STATION/OFFSET	TOP ELEV (NAVD88)	OBSTRUCT MARKING
①	DOT&PF MAINTENANCE BUILDING	9+68/315' RT	46'	NONE
②	MAIL STORAGE BUILDING	9+43/335' RT	36'	NONE

ROFZ PENETRATIONS		
ID #	DESCRIPTION	DISPOSITION
Ⓐ	BRUSH*	REMOVE

*BRUSH ALONG BOTH SIDES OF THE RUNWAY.

BY	DATE	REVISION

UGASHIK AIRPORT
 UGASHIK, ALASKA
 AIRPORT LAYOUT PLAN

DATE: 02/06/2009
 SHEET: 2 OF 3

Date Plotted: 12/20/2009, 1:40 PM
 Layout Name: P77(3)
 File Name: P:\Projects\0594225\UGASHIK\ALP\ALP-UGASHIK.dwg
 Designed By: nllwellin
 Drawn By: boquin
 Checked By: bhanson

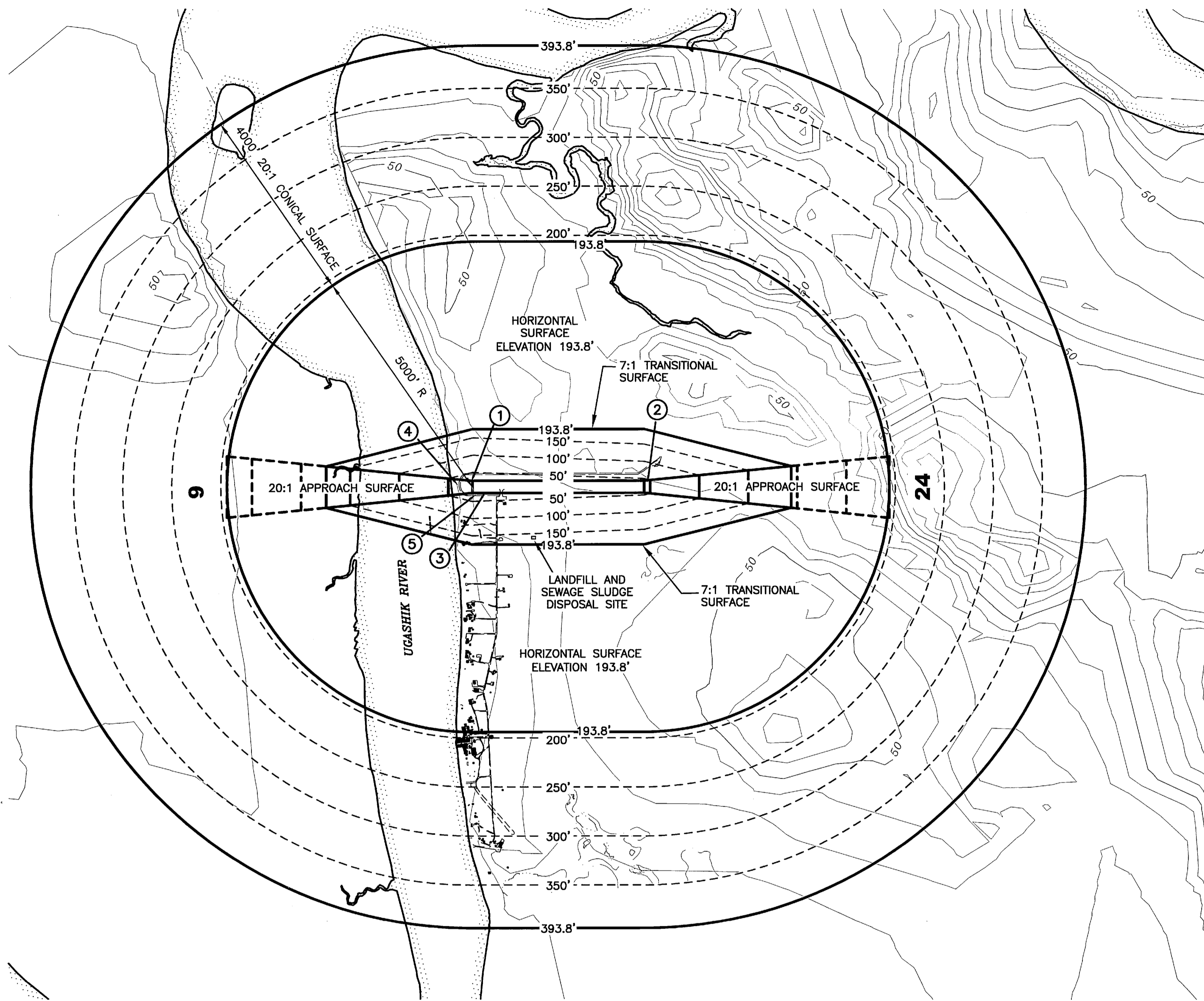

PART 77 SURFACE OBSTRUCTIONS TABLE								
ID #	DESCRIPTION	STATION/OFFSET	ELEVATION	SURFACE PENETRATED	SURFACE ELEVATION	AMOUNT PENETRATION	DISPOSITION	STAGE TO CORRECT
1	BRUSH	3+00/0	28.5'	APPROACH	25.5'	3'	REMOVE	NEAR-TERM
2	BRUSH	38+00/0	46.8'	APPROACH	43.8'	3'	REMOVE	NEAR-TERM
3	BRUSH	*/60'	VARIES	PRIMARY	VARIES	1' - 9'	REMOVE	NEAR-TERM
4	ROAD	0+70/0	39'	APPROACH	37'	2'	REMAIN	
5	ROAD	VARIES/165'RT	39'**	TRANSITIONAL	29.7'	9'	REMAIN	

*ISOLATED AREAS BOTH SIDES OF THE RUNWAY.
 ** USED HIGHEST POINT OF ROAD TO DETERMINE ELEVATION

NOTES

- AIRPORT ELEVATION IS 43.8'.
- PRIMARY SURFACE WIDTH IS 250'.
- TOPO CONTOURS ARE SHOWN IN FEET. BASEMAP DATA FROM USGS UGASHIK (C-5).
- A RANGEFINDER WITH BUILT-IN INCLINOMETER WAS USED TO IDENTIFY OBSTRUCTIONS CLOSE TO THE RUNWAY IN THE PRIMARY AND TRANSITIONAL SURFACES.
- APPROACH SURFACES ARE 20:1, BEGINNING 200' BEYOND THE THRESHOLDS.
- THE RUNWAY 6 CONTROLLING OBSTRUCTION IS BRUSH AT STATION 3+00, ON RUNWAY CENTERLINE, ELEVATION IS 3' ABOVE RUNWAY. THE OBSTRUCTION CLEARANCE SLOPE IS 1:1, PER FAA AC 150/5200-35, SECTION 4.
- THE RUNWAY 24 CONTROLLING OBSTRUCTION IS BRUSH AT STATION 38+00, ON RUNWAY CENTERLINE, ELEVATION IS 3' ABOVE RUNWAY. THE OBSTRUCTION CLEARANCE SLOPE IS 1:1, PER FAA AC 150/5200-35, SECTION 4.
- THERE ARE NO OBJECT PENETRATIONS IN THE APPROACH END SITING SURFACE OF RUNWAY 6, AS DEFINED IN FAA AC 150/5300-13, TABLE A2-1, ROW 1.
- THERE ARE NO OBJECT PENETRATIONS IN THE APPROACH TO RUNWAY 24, AS DEFINED IN FAA AC 150/5300-13, TABLE A2-1, ROW 1.
- THERE ARE NO KNOWN HEIGHT RESTRICTIONS. UGASHIK IS UNINCORPORATED. LAKE AND PENINSULA BOROUGH CODES DO NOT ADDRESS STRUCTURE HEIGHTS.
- THE LANDFILL AND SEWAGE SLUDGE DISPOSAL SITE ARE LOCATED 1012' FROM THE RUNWAY.

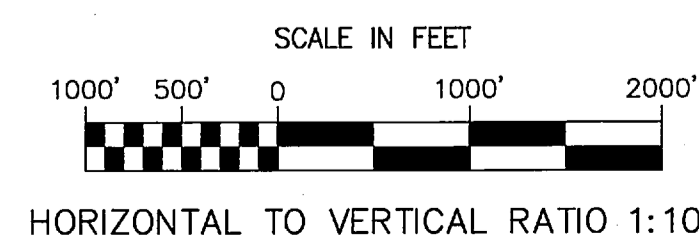
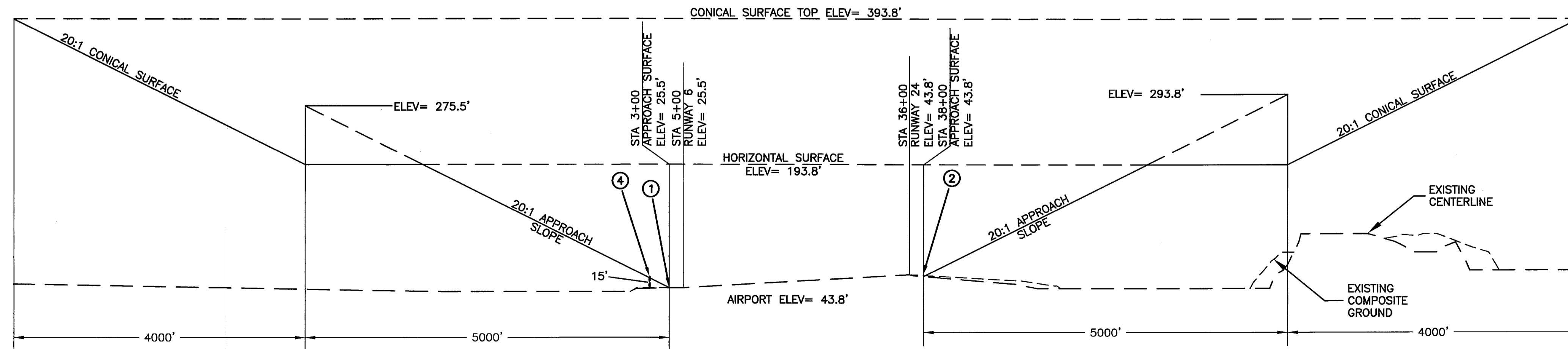
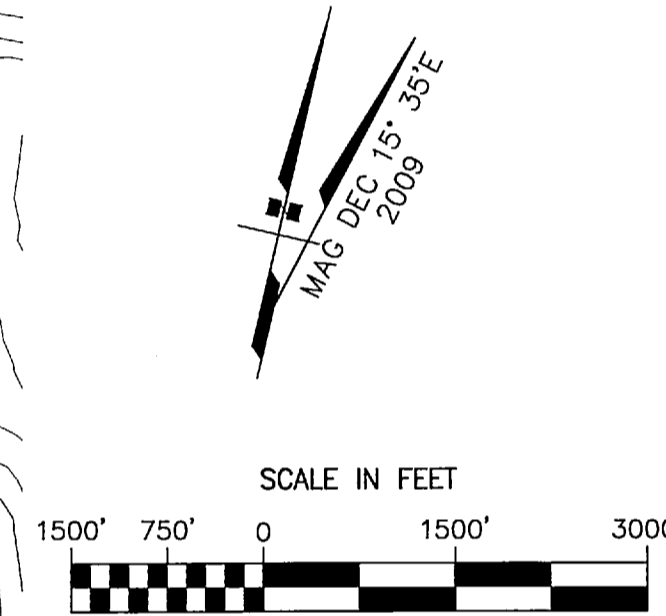

RUNWAY PROFILE

BY	DATE	REVISION
UGASHIK AIRPORT UGASHIK, ALASKA AIRPORT LAYOUT PLAN AIRPORT AIRSPACE		
		DATE: 02/06/2009
		SHEET: 3 OF 3